



Specification sheet

PVE 32VM

Vibro Hammer

English

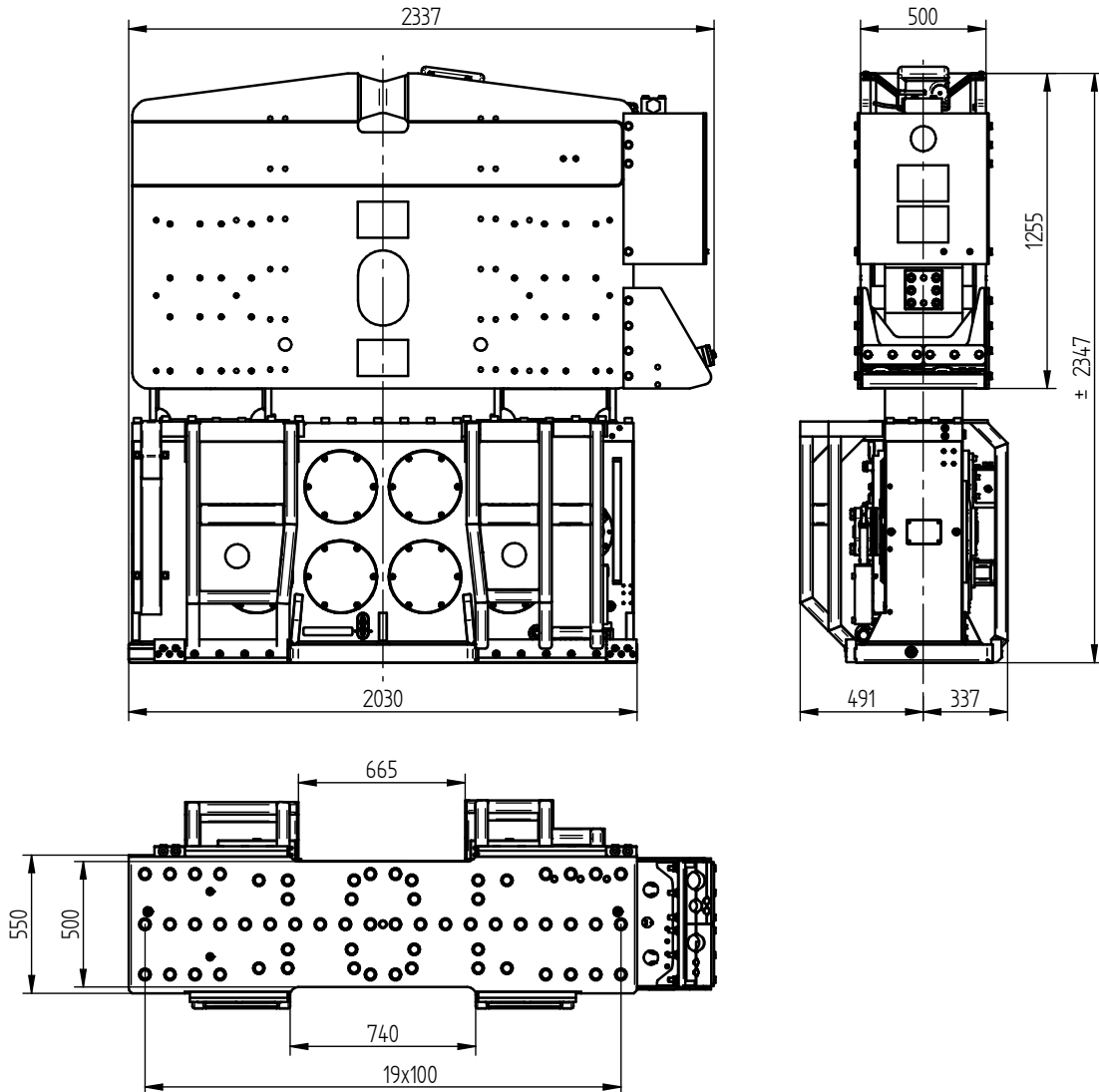

Specifications :

PVE 32VM

Eccentric moment	0-32 kgm	Clamps:	
Centrifugal force	0-1856 kN	Sheet pile clamp	200TU-P
Max. frequency	2300 rpm	Transport weight per piece	2000 kg
Max. amplitude excl. 200TU-P	15 mm	Double clamps	125TC
Max. amplitude incl. 200TU-P	10,2 mm	Transport weight per piece	900 kg
Max. static line-pull	500 kN		
Max. pull-down	300 kN		
Max. operating pressure	350 bar	Powerpack:	
Max. oil flow	740 l/min	Model	800 series
Max. hydraulic power	432/588 kW/HP		
Forced lubrication	yes		
Dynamic weight excl. 200TU-P	4300 kg	Hose set:	
Dynamic weight incl. 200TU-P	6300 kg	Length	45 m
Total weight excl. 200TU-P & hoses	6800 kg	Transport weight (±)	1121 kg



Technische Daten

PVE 32VM

Vibro Hammer

Deutsch

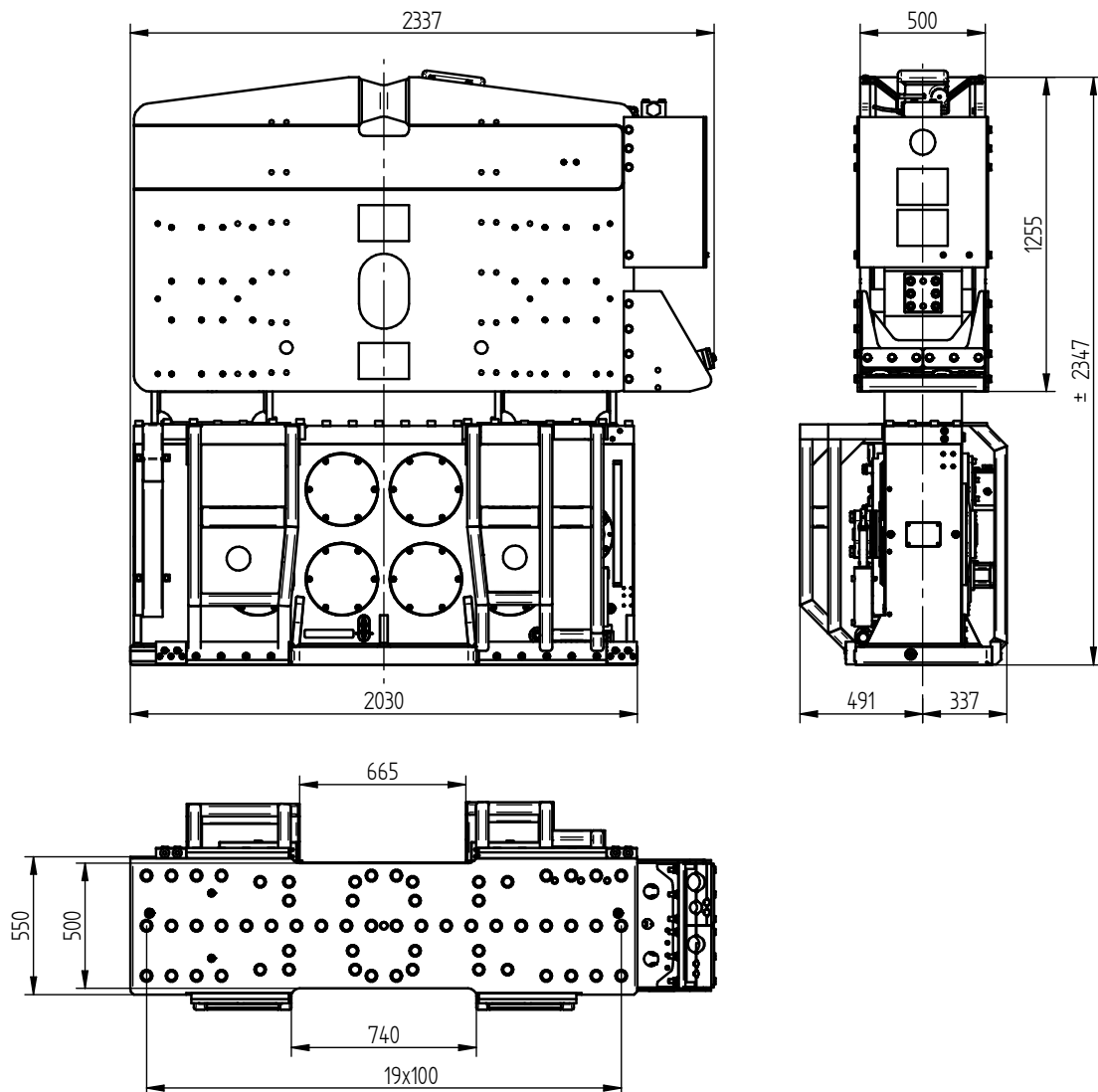

Technische Daten :		PVE 32VM	
Statisches Moment	0-32 kgm	Klemmzange:	
Max. Fliehkraft	0-1856 kN	Universalzange	200TU-P
Max. Drehzahl	2300 rpm	Transportgew. pro Stück	2000 kg
Max. Amplitude ohne 200TU-P	15 mm	Rohrklemmzange	125TC
Max. Amplitude mit 200TU-P	10,2 mm	Transportgew. pro Stück	900 kg
Max. Statische Zugkraft	500 kN		
Max. Vorspannung	300 kN		
Max. Betriebsdruck	350 bar	Aggregat:	
Max. Fördermenge	740 l/min	Modell	800 series
Max. hydraulische Leistung	432/588 kW/PS		
Zwangsschmierung	ja		
Dyn. Gewicht ohne 200TU-P	4300 kg	Schlauchsatz:	
Dyn. Gewicht mit 200TU-P	6300 kg	Länge	45 m
Gesamtgew. Ohne 200TU-P & Schläuche	6800 kg	Transportgewicht (±)	1121 kg



Spécifications

PVE 32VM

Vibro Hammer

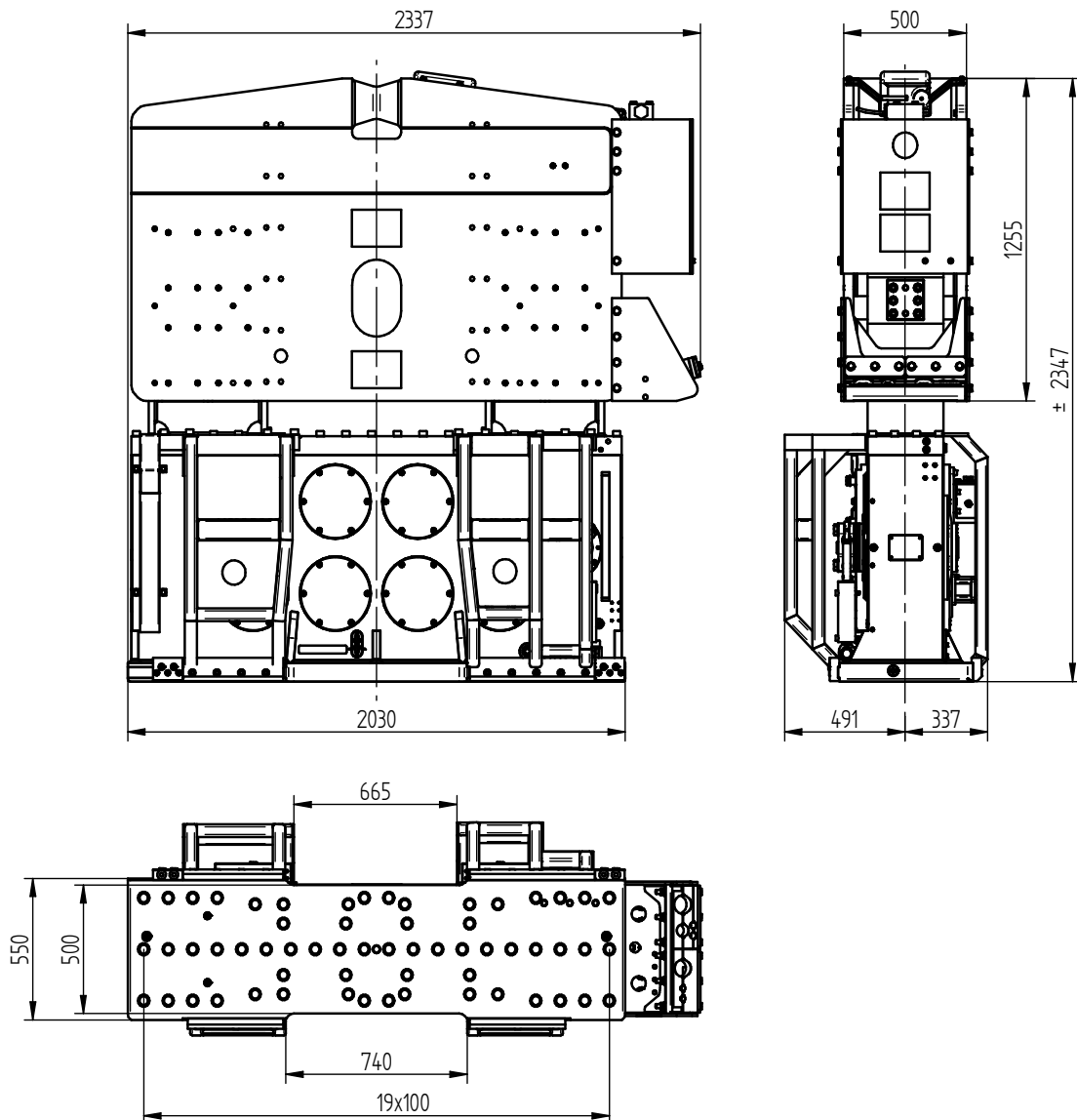

Spécifications		PVE 32VM	
Moment excentrique	0-32 kgm	Pinces:	
Max. force centrifuge	0-1856 kN	Pince palplanche	200TU-P
Max. fréquence	2300 rpm	Poids de transport par pièce	2000 kg
Max. amplitude sans 200TU-P	15 mm	Pince tube	125TC
Max. amplitude avec 200TU-P	10,2 mm	Poids de transport par pièce	900 kg
Force de traction statique	500 kN		
Force maximale d'appui	300 kN		
Pression de travail max.	350 bar	Groupe hydraulique:	
Débit d'huile max.	740 l/min	Modèle	800 series
Puissance hydraulique max.	432/588 kW/ch		
Huile lubrifiante	oui		
Poids dynamique sans 200TU-P	4300 kg	Jeu de tuyau:	
Poids dynamique avec 200TU-P	6300 kg	Longueur	45 m
Poids total sans 200TU-P & tuyaux	6800 kg	Poids de transport (±)	1121 kg

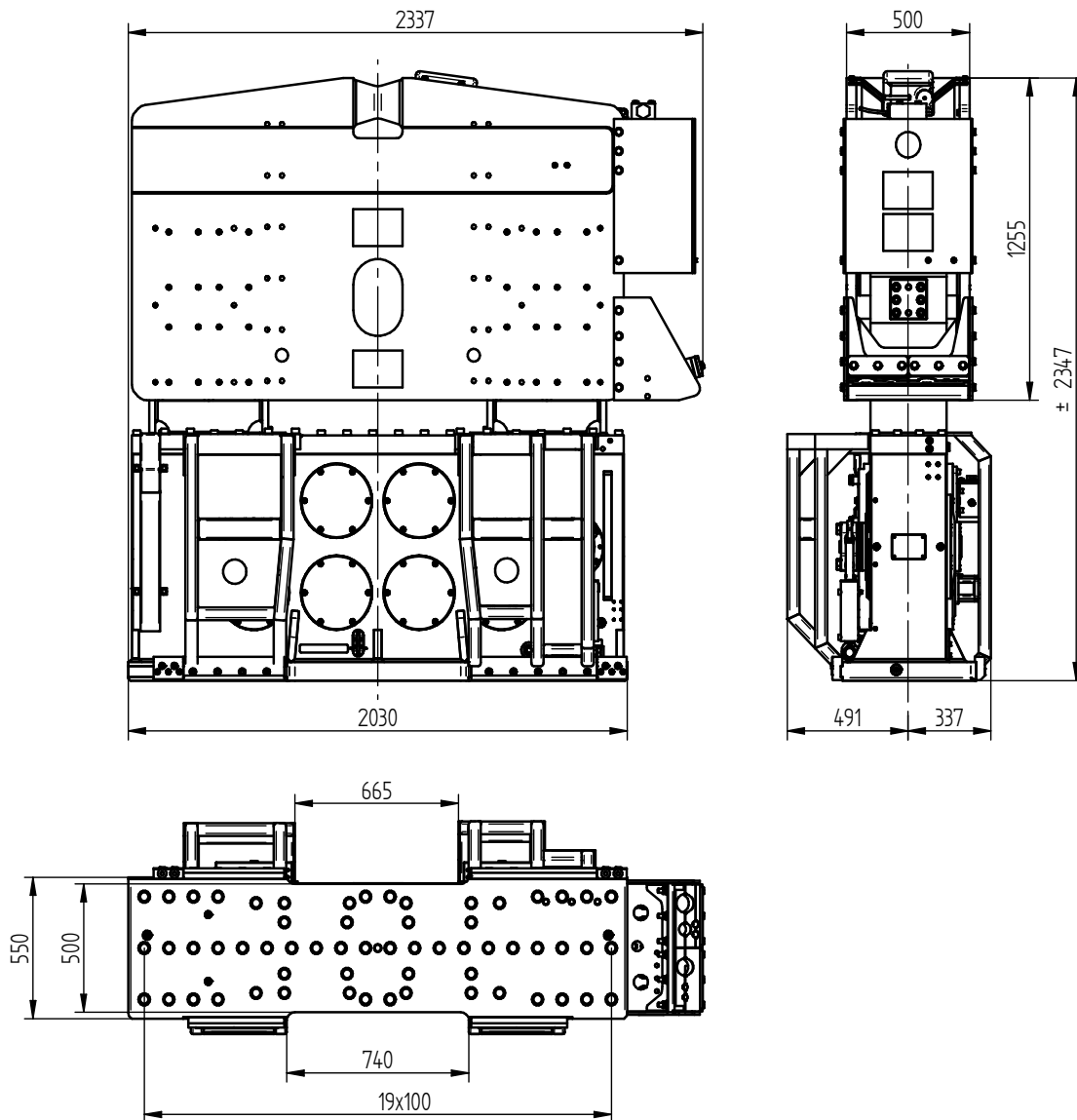

Specificaties

PVE 32VM

Excentrisch moment	0-32 kgm	Klemmen:	
Max. centrifugaalkracht	0-1856 kN	Damwandklem	200TU-P
Max. toerental	2300 rpm	Transportgewicht per klem	2000 kg
Max. amplitude excl. 200TU-P	15 mm	Pijpenklem	125TC
Max. amplitude incl. 200TU-P	10,2 mm	Transportgewicht per klem	900 kg
Max. statische trekkracht	500 kN		
Max. voorspanning	300 kN		
Max. werkdruk	350 bar	Aggregaat:	
Max. oliedoorstroming	740 l/min	Model	800 series
Max. hydraulisch vermogen	432/588 kW/PK		
Geforceerde smering	ja		
Dynamisch gewicht excl. 200TU-P	4300 kg	Slangenset:	
Dynamisch gewicht incl. 200TU-P	6300 kg	Lengte	45 m
Totaalgewicht excl. 200TU-P & slangen	6800 kg	Transportgewicht (±)	1121 kg



Especificaciones

PVE 32VM

Vibro Hammer

Español

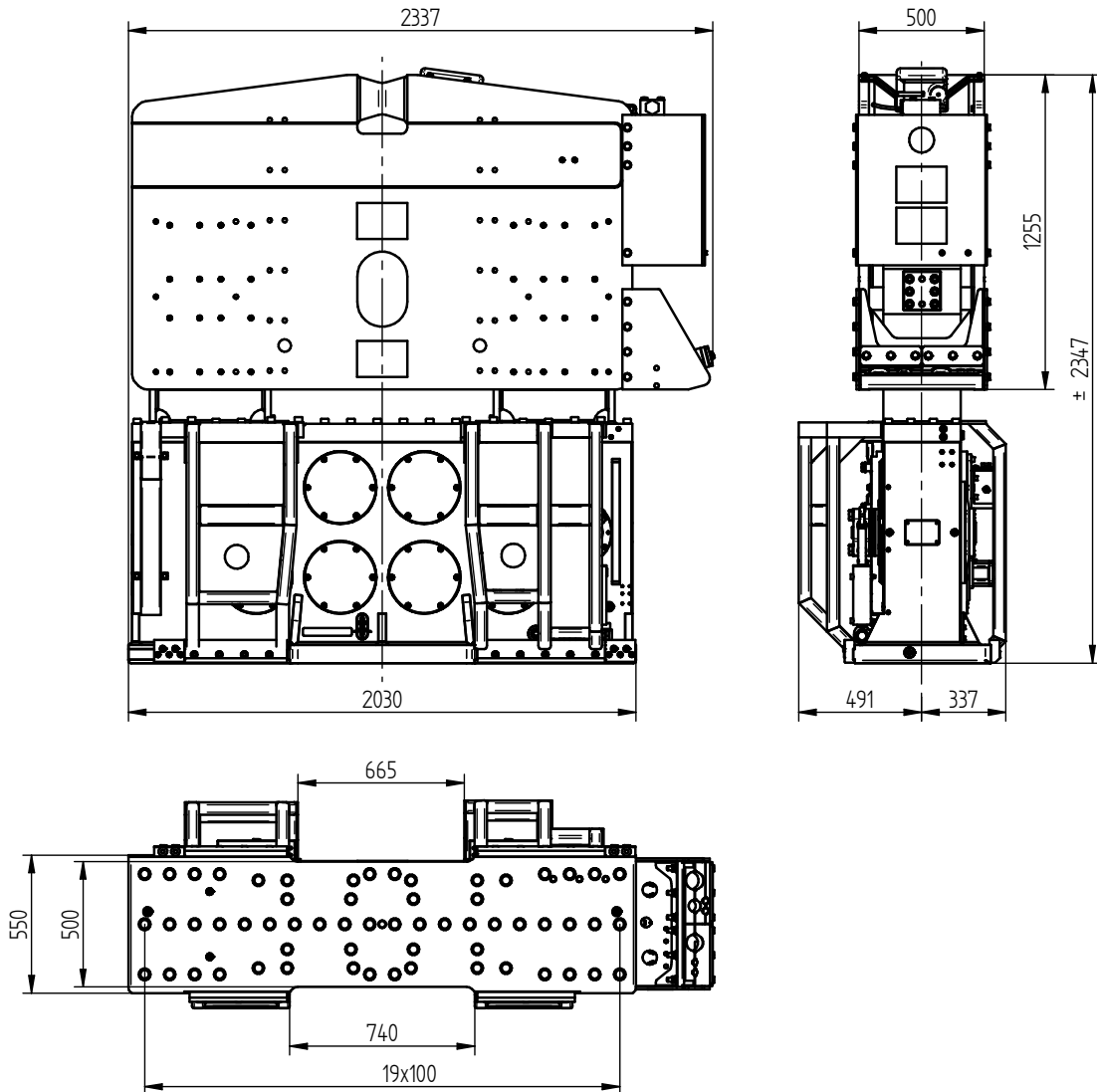

Especificaciones		PVE 32VM	
Momento excéntrico	0-32 kgm	Abrazadera:	
Fuerza centrífuga máxima	0-1856 kN	Hoja abrazadera pila	200TU-P
Frecuencia máxima	2300 rpm	Peso de transporte por pieza	2000 kg
Amplitud máxima excluyendo 200TU-P	15 mm	Abrazadera de tubo	125TC
Amplitud máxima incluyendo 200TU-P	10,2 mm	Peso de transporte por pieza	900 kg
Estático tracción máxima	500 kN		
Compresión máxima	300 kN		
Presión máxima de trabajo	350 bar	Unidad de potencia:	
Flujo de aceite máximo	740 l/min	Modelo	800 series
Máxima potencia hidráulica	432/588 kW/HP		
Lubricación forzada	si		
Peso dinámico excluyendo 200TU-P	4300 kg	Conjunto de manguera:	
Peso dinámico incluyendo 200TU-P	6300 kg	Longitud	45 m
Peso total excluyendo 200TU-P & mangueras	6800 kg	Peso de transporte (±)	1121 kg

Specifications

PVE 32VM

Vibro Hammer

USA

Dimensions in inches

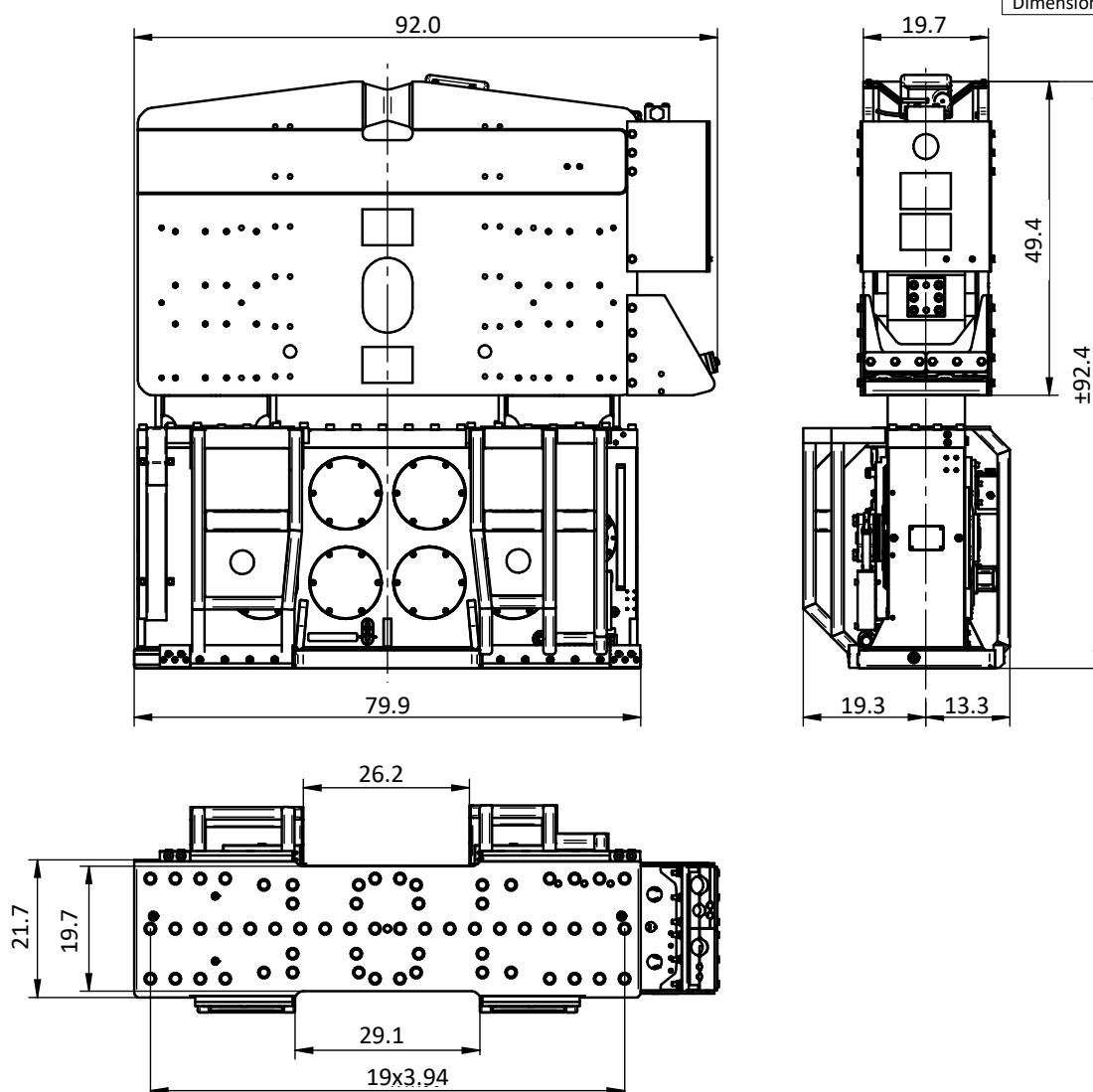

Specifications		PVE 32VM	
Eccentric moment	0-2,778 in-lbs	Clamps:	
Centrifugal force	0-209 ton	Sheet pile clamp	200TU-P
Max. frequency	2,300 rpm	Transport weight per piece	4,409 lbs
Max. amplitude excluding 200TU-P	0.59 in	Double clamps	125TC
Max. amplitude including 200TU-P	0.4 in	Transport weight per piece	1,984 lbs
Max. static line-pull	56 ton		
Max. pull-down	34 ton		
Max. operating pressure	5,076 psi	Powerpack:	
Max. oil flow	195 gal/min	Model	800 series
Max. hydraulic power	432/588 kW/HP		
Forced lubrication	yes		
Dynamic weight excluding 200TU-P	9,480 lbs	Hose set:	
Dynamic weight including 200TU-P	13,889 lbs	Length	148 ft
Total weight excluding 200TU-P & hoses	14,991 lbs	Transport weight (±)	2,471 lbs



Specificatii

PVE 32VM

Ciocan cu vibratii

romănesc

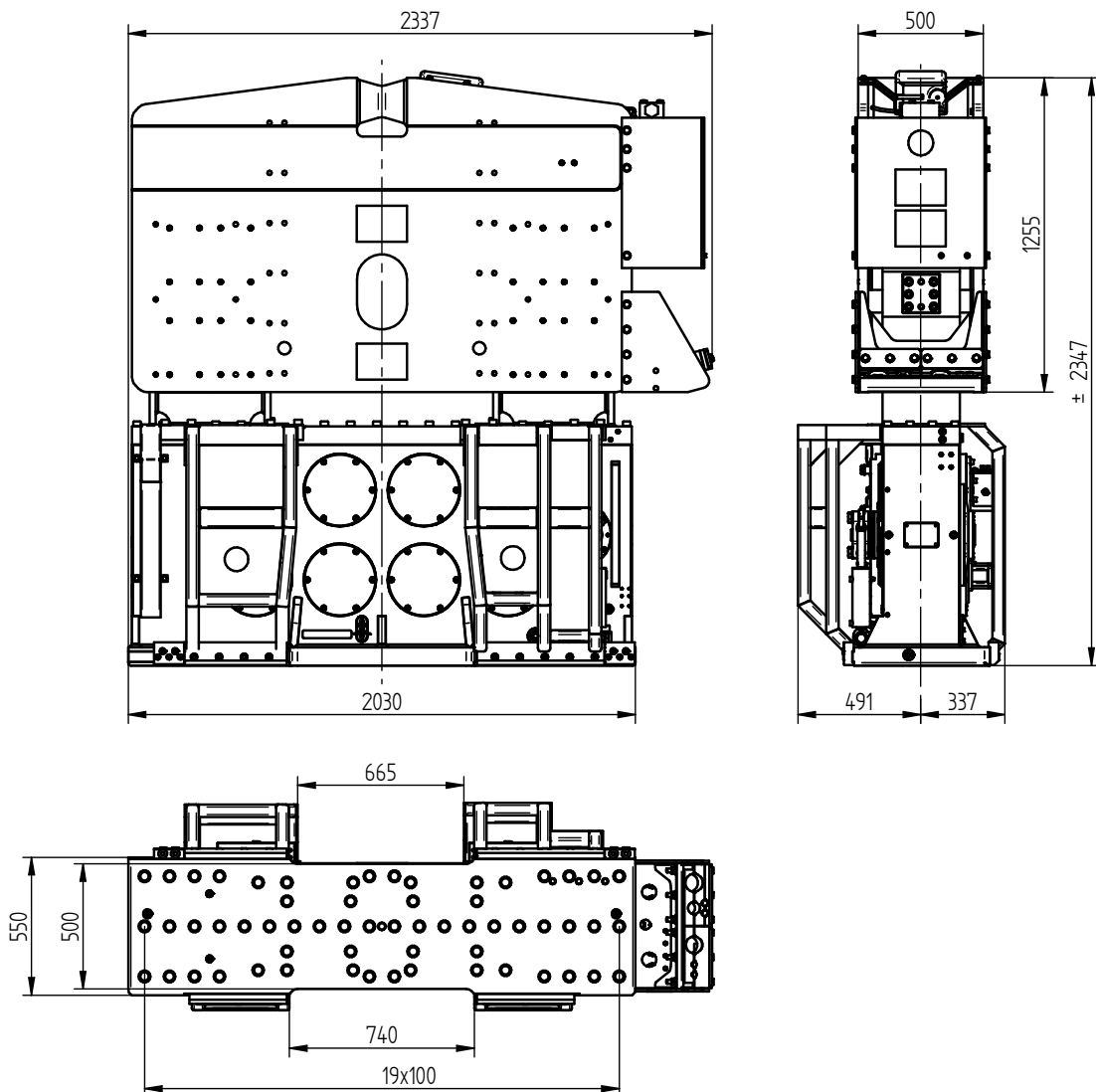
**Specificatii :****PVE 32VM**

Moment excentric	0-32 kgm	menghira:	
Forta centrifuga maxima	0-1856 kN	menghina pentru palplase	200TU-P
Frecventa maxima	2300 rpm	Greutatea de transport pp.	2000 kg
Amplitudine maxima exclusiva. 200TU-P	15 mm	menghina dubla	125TC
Amplitudine maxima inclusivă. 200TU-P	10,2 mm	Greutatea de transport pp.	900 kg
Tractie maxima statica	500 kN		
Trage în jos maxima	300 kN		
Presiune maxima de lucru	350 bar	generatoare:	
Debit maxim de ulei	740 l/min	Model	800 series
Puterea hidraulică maxima	432/588 kW/HP		
Lubrifiere forzata	da		
Greutatea dinamica exclusiva. 200TU-P	4300 kg	Tip de furtun:	
Greutatea dinamica inclusivă. 200TU-P	6300 kg	Lungimea	45 m
Greutatea totala fara. 200TU-P si furtun	6800 kg	Greutatea de transport (±)	1121 kg